

Quick Reference Guide

Nalu Therapy Disc and
Remote Programmer Application



Therapy Disc Features

Down Button

- Decrease Stimulation
- Dismiss and reactivate alerts

Up Button

- Increase Stimulation



Buzzer

- Indicates Therapy Disc Status

LED (white, blue, green, orange)

- Indicates Therapy Disc Status

ON/OFF Program

- Turns Therapy Disc on/off
- Changes stimulation

Turning Stimulation On/Off

Press and release the ON / OFF Program button.

OR

Remove the Therapy Disc from the clip.



OR

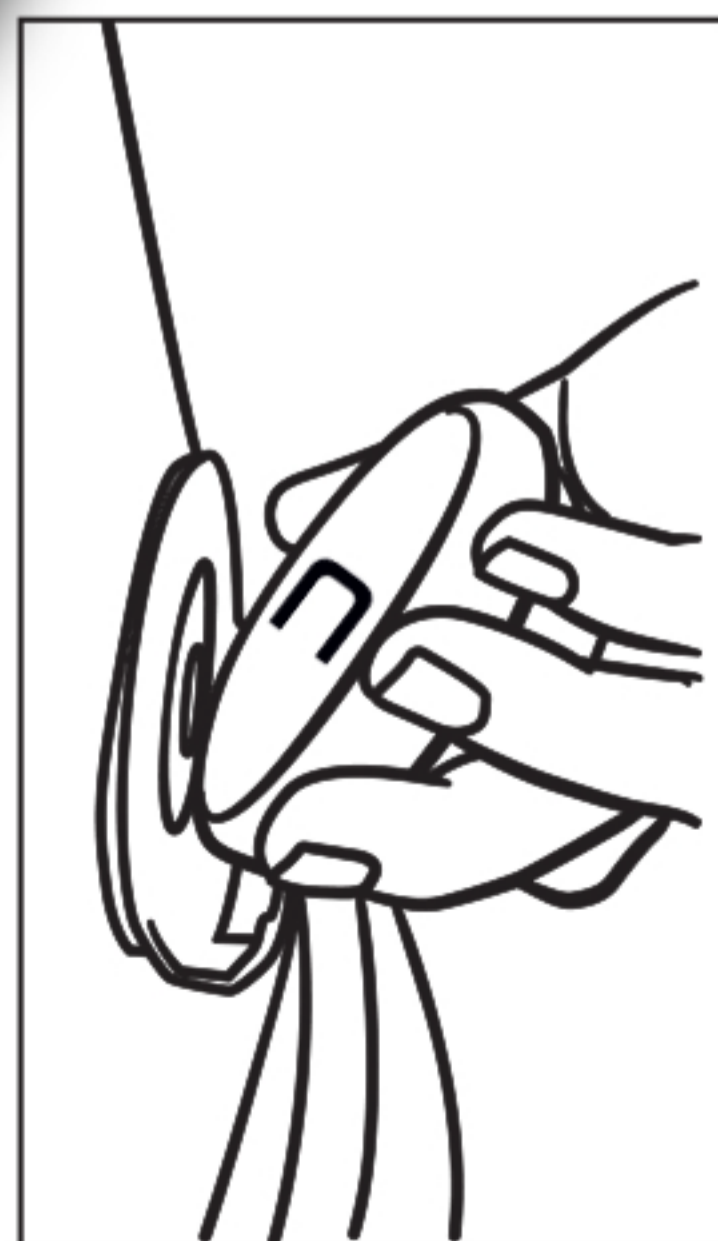

Adjusting Stimulation Strength

Increasing Stimulation from the Therapy Disc

1. Press and release the Up button.
2. The green LED will blink after each button press.

Decreasing Stimulation from the Therapy Disc

1. Press and release the Down button.
2. The green LED will blink after each button press.

Down Button

- Decrease Stimulation
- Dismiss and reactivate alerts

Up Button

- Increase Stimulation



Changing Stimulation Program

1. Press and release the ON / OFF Program button.
2. The green LED will blink after the button press. The selected program will be indicated by the number of LED blinks.





Please refer to the patient manual for complete instructions and for applicable warnings and precautions.

Starting a Therapy Program

To start the program from the Home screen:

1. Select the program that you want to start.
2. Tap the  icon.
3. The therapy will start.

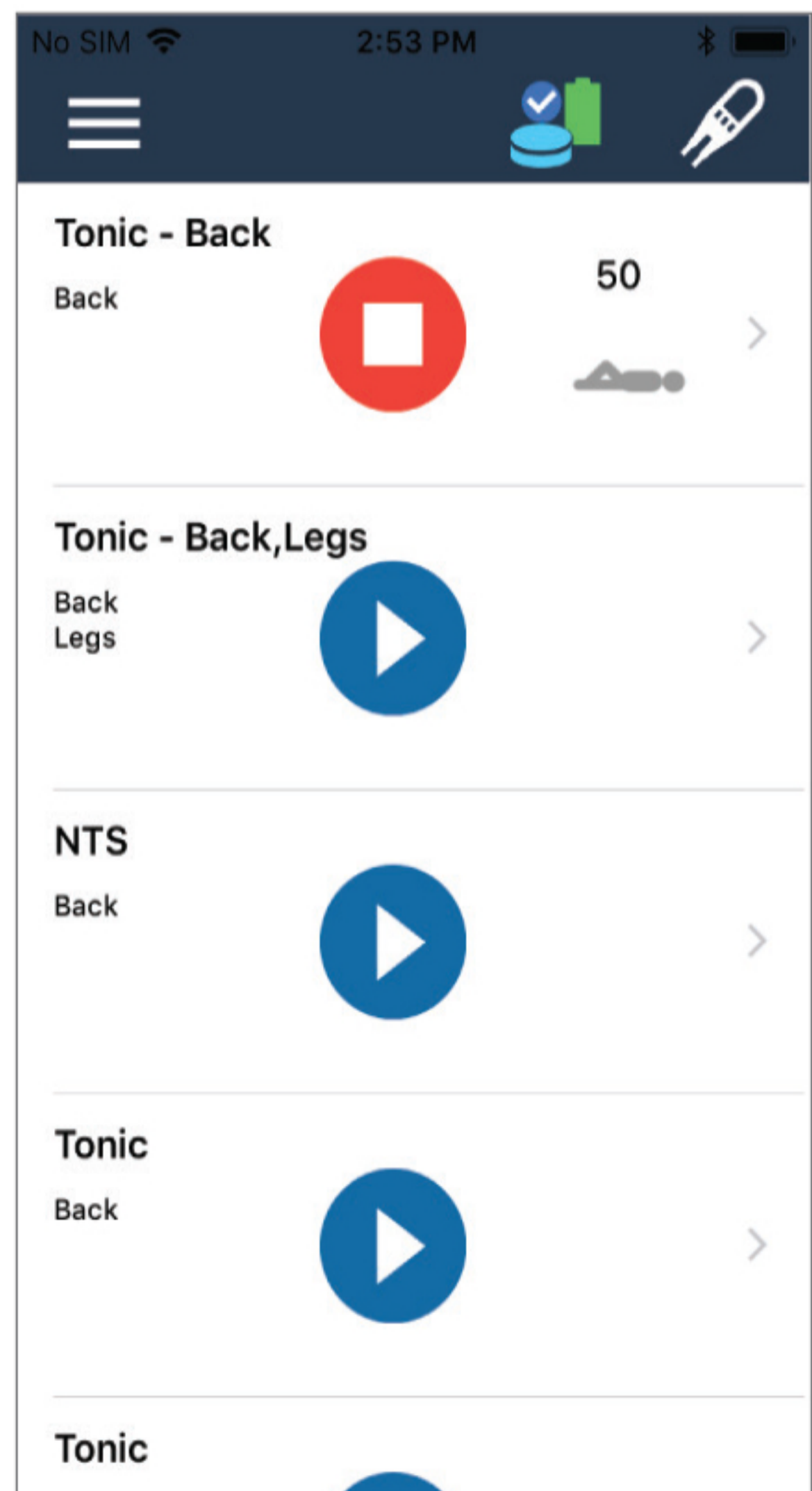

To start the program from the Program Details screen:

1. On the Home screen, select the program you want to execute.
2. Tap the navigation  icon. The Program Details screen will appear, displaying the posture and pulse amplitude settings.
3. Tap  to start the program.
4. Select the posture and adjust the pulse amplitude.
5. The therapy will start.



Changing Therapy Amplitude

You can view the range of therapy amplitude (blue) in the progress bar as well.

The therapy amplitude percentage is 50% by default. You can increase or decrease the pulse amplitude percentage by tapping the  or  tab.

After you start the program by tapping the  icon, the posture and therapy amplitude tabs will be enabled.

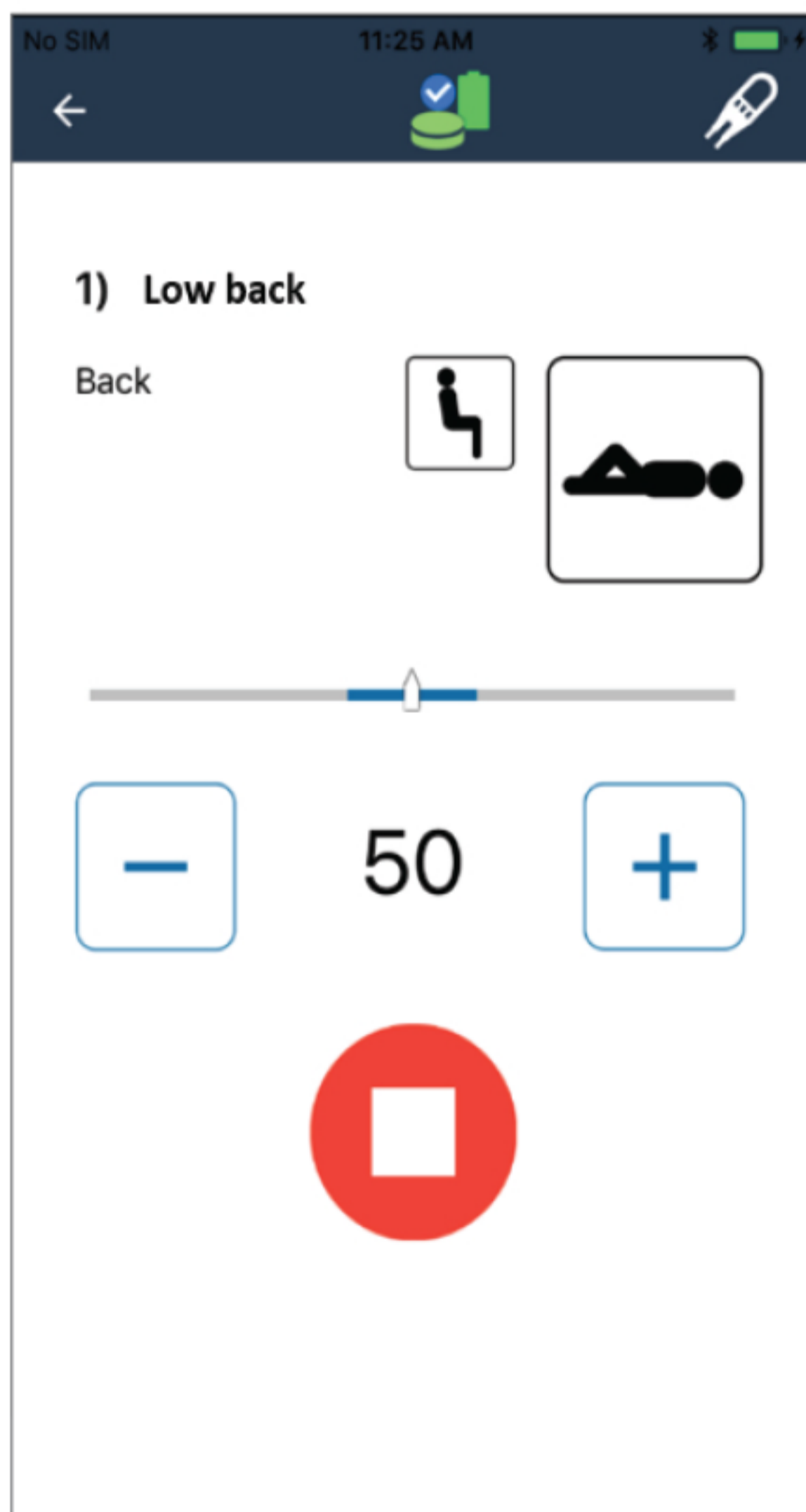

Therapy Disc Status

Status of the blue & green Therapy Discs

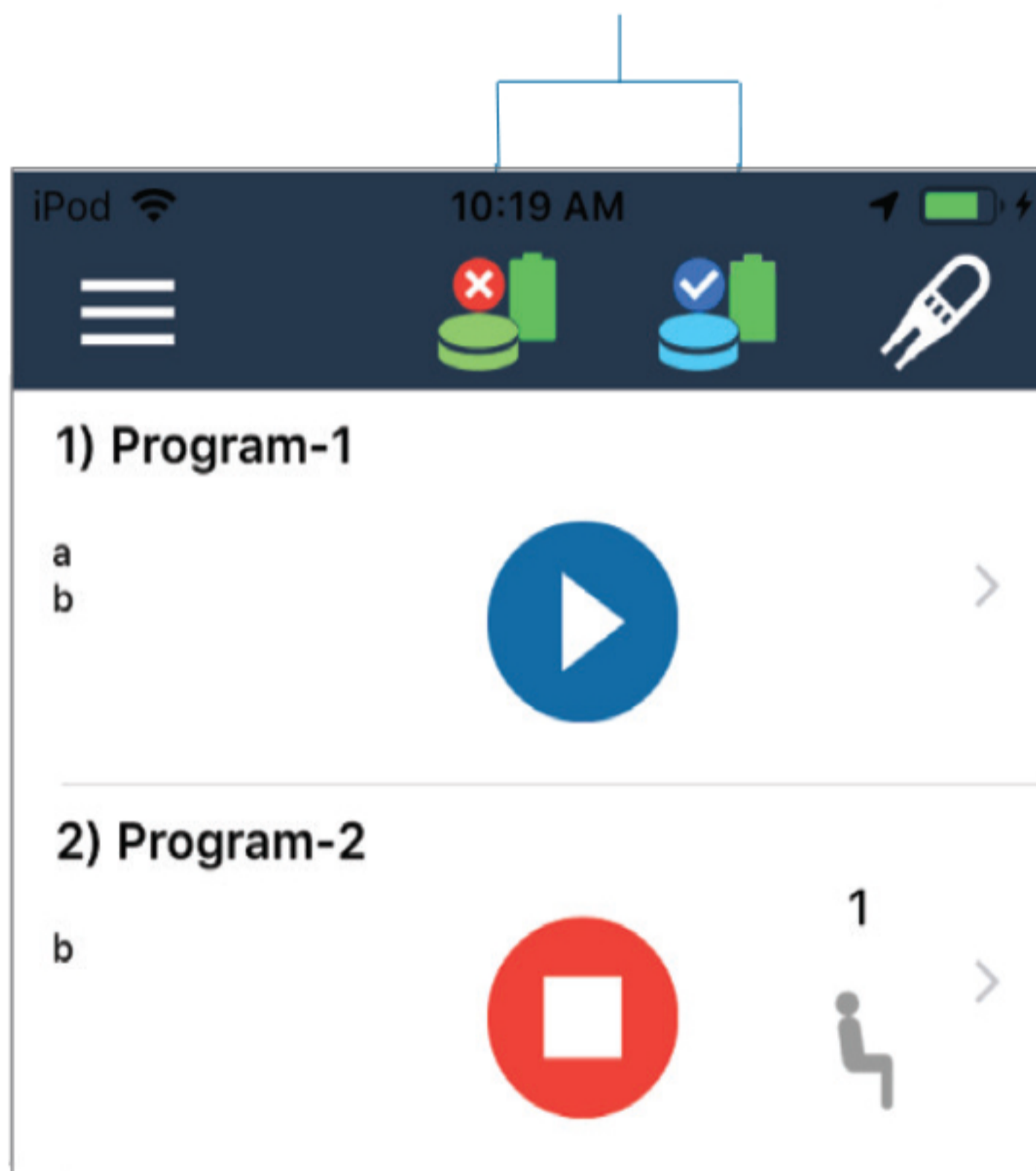

Therapy Disc is off or out of range.



Therapy Disc is not producing therapy.



Therapy Disc is producing therapy.

Icon Definitions



Start button for most recent therapy



Start Button - Press to begin therapy



Stop Button - Press to stop therapy

Troubleshooting



If application is not working correctly, please restart the application and Therapy Disc.



If Therapy Disc is not connecting, ensure Therapy Disc and device are within range and no objects are blocking the connection.



Scan QR code for
Instructions for Use



nalumed.com/ifus



MANUFACTURER
Nalu Medical, Inc.

2320 Faraday Avenue, Suite 100
Carlsbad, California 92008 USA
Telephone: +1 800 618 3402
Customer Service: info@nalumed.com
Technical Support: support@nalumed.com
www.nalumed.com